

Tape & Reel 3Kpcs

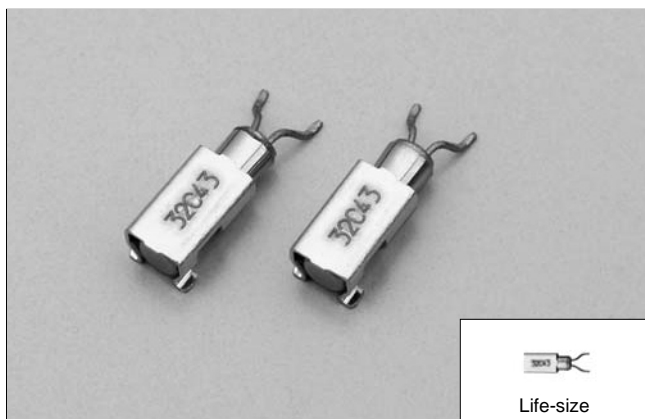

Tuning fork Crystal Unit



◆ Features

- High-density mounting SMD with jacket.
- Automatic mounting and reflowable type.
- Most appropriate for clock source for portable and other various equipment with low powerconsumption.

◆ Dimensions (mm)

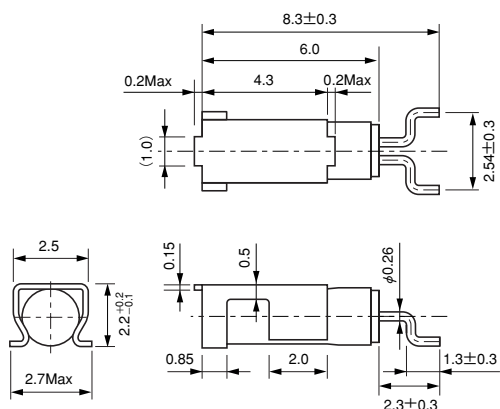

◆ Solder pad layout (mm)

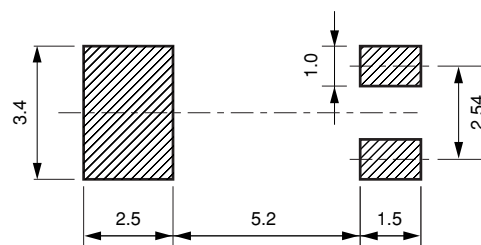

◆ Standard Specifications

Part Numbering system is in Page 14, [click here](#)

Item	Model	MXC206J	Conditions
Nominal Frequency	f ₀	32.768KHz	
Frequency Tolerance	Δf/f ₀	±20ppm	at 25°
Load capacitance	C _L	12.5 pF	Need to specify your requirement
Operating Temperature Range	T _{OPR}	-40°C~+85°C	
Storage Temperature Range	T _{STR}	-55°C~+125°C	
Turnover Temperature	T _M	25°C±5°C	
Temperature Coefficient	β	-0.034±0.006ppm/°C ²	
Motional (series) resistance	R ₁	50K Ω Max.	at 25°C
Level of drive	D _L	1 μ W Max.	
Aging (first year)	Δf/f ₀	±3ppm Max.	25°C±3°C
Quality Factor	Q	70000 Typ.	
Shunt capacitance	C ₀	1.35pF Typ.	

MDX codification 32,768 KHz Crystals (Part Numbering System)



Case	Frequency code	Tolerance at 25°C (ppm)	Load capacitance	Packing Specification
MFS206	- 32	D	F	T
↓	↓	↓	↓	↓
<p>MFS206</p> <p>MXC200T</p> <p>MXC206J</p> <p>MXC200S</p> <p>MXC519</p> <p>MXC415</p> <p>MXC315</p> <p>MXC212</p>	<p>32,768 KHz</p>	<p>D = +/- 20 ppm</p> <p>F = +/- 15 ppm</p> <p>E = +/- 10 ppm</p> <p>H = +/- 5 ppm</p>	<p>A = Series</p> <p>B = 6.0pF</p> <p>C = 9.0pF (STD)</p> <p>D = 9.5pF</p> <p>E = 12.0pF</p> <p>F = 12.5pF (STD)</p> <p>G = 13.0pF</p> <p>Q = 10.0pF</p> <p>S = 11.0pF</p> <p>V = 8.0pF</p> <p>Y = 7.0pF</p> <p>Z = Others</p>	<p>T = Tape & Reel</p> <p>B = Bulk</p>